

800 x 1200 x 50mm

Edition : 1.0
Date: (02/25)

Instruction Manual

NITRIDE STEEL WELDING TABLE TOP & TRAY WT16-1208T/K

Order Code: (W07806/K)

1.2 PARTS LIST

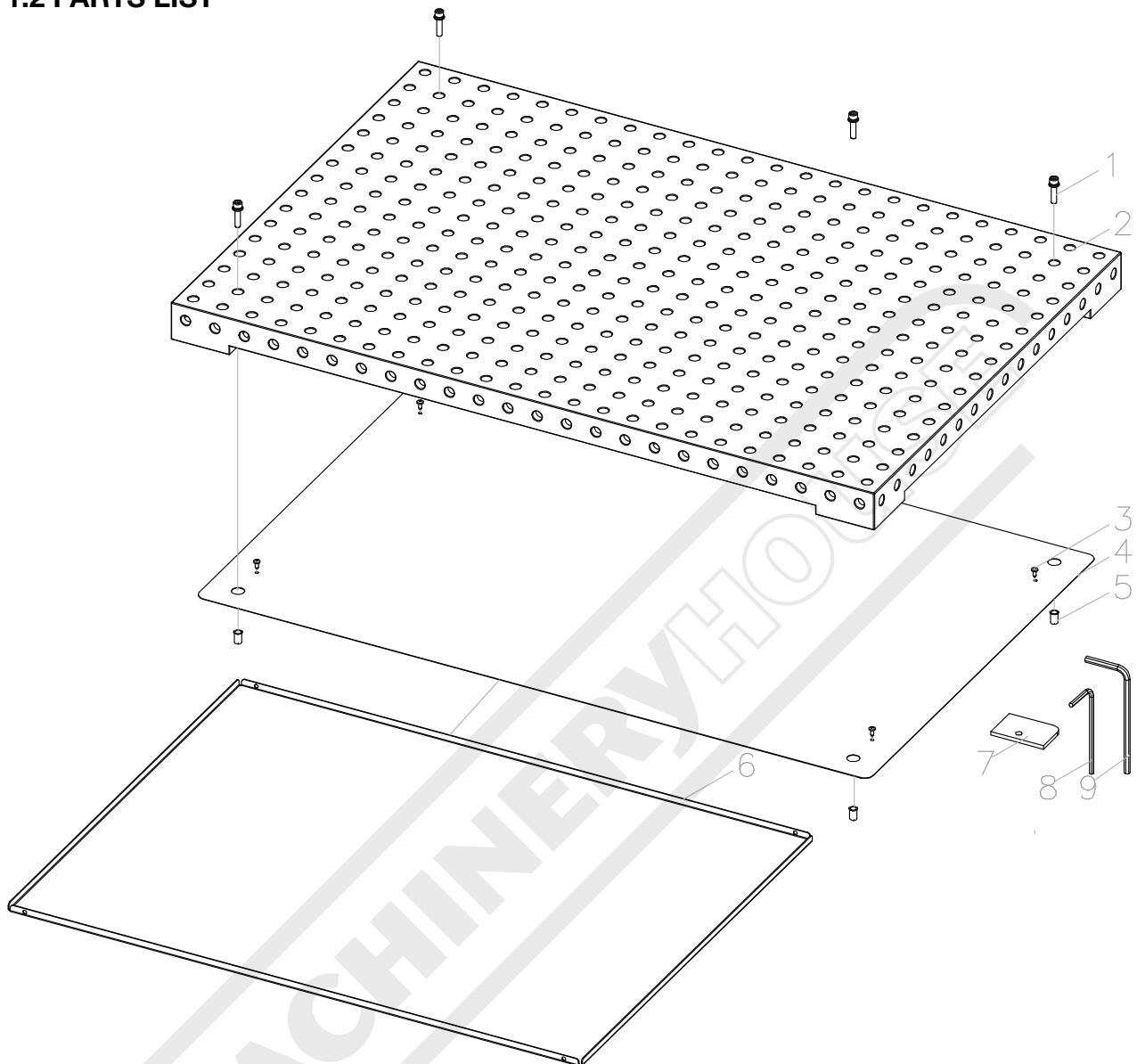

Part No.	Description	Quantity
1	Socket Head Cap Screws M8x35	4
2	Welding Table	1
3	Wood Screws M4x16	4
4	Panel	1
5	Threaded Inserts M8x20	4
6	Tray	1
7	Drill Jig	1
8	Allen Key S6	1
9	Allen Key S8	1

BEFORE ASSEMBLING

Please read this instruction manual before assembly.



CAUTION

Before assembly please pay attention to the following points in priority;

Confirmation of components: Before assembling, please confirm all parts arrived and are in good order.

Site for assembly: Please assemble it on the soft floor such as smooth carpet and flannel blanket.
When you assemble on wooden floor, please put thin towels on the floor.

Points for attention when assembling: Please wear gloves to ensure that it can be assembled safely, and use two persons to help in the assembly process.

SAFETY INFORMATION

1. Do not pull this Welding Table Station when fitted to mobile table, push it when moving.
2. Engage both brakes when this Welding Table Station is not being moved. This prevents it rolling away.
3. Secure this Welding Table Station properly before moving with a forklift.
4. Do not tow this Welding Table Station with power equipment.
5. Do not alter this Welding Table Station in any manner. For Example. Do not weld external lock bars or attach electrical equipment.
6. Before locking the Welding Table Station, ensure the drawers are completely closed in order for the lock bars to work properly.



CAUTION: Do not attach or mount this product to a vehicle. This may cause personal injury or product damage. Mounting this product to any vehicle in any manner will void warranty.



CAUTION: Keep the product on level surfaces. The product may become unstable and tip if stored or moved on an un-level surface, which may cause personal injury or product damage.



CAUTION: Do not stand on this product. You may fall which may cause personal injury or product damage.



CAUTION: Lock the drawers before moving this product. The drawers could come open and make the product unstable and tip, which may cause personal or product damage.



CAUTION: When mounted to workstation, be careful when opening more than one drawer. The product may become unstable and tip, which may cause personal injury or product damage.



CAUTION: Use safety shoes as all times.



CAUTION: Beware of hazards such as falling parts, clamps or heavy objects.



CAUTION: Do not place tools or other parts on the table top during assembly.



CAUTION: Note the weight of the Table Top. Only install welding table if you have suitable lifting equipment. If not available, commission and use a professional lifting company.



CAUTION: When lifting the table top it must be secured against falling, Only work on a secured table top and never step under it.



ASSEMBLY INSTRUCTIONS

Welding Table Top is designed to fit straight onto the TWS-622 Mobile Work Station.
(Order Code: T6890).



TOOLS & ASSISTANCE NEEDED

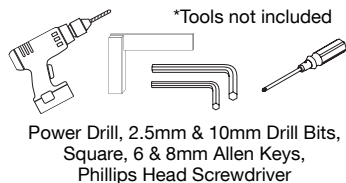

STEP 1.

Drill Jig

- Position Drill Jig (7) on each corner of the work bench making sure the edges are flush, use a square to align edges.
- Using a Ø10mm Drill bit and drill down 20+0.5mm deep through the hole in the Drill Jig (7). as per Fig. 1.
- Repeat to all four corners. Flip over the Drill Jig (7) on the opposite sides.

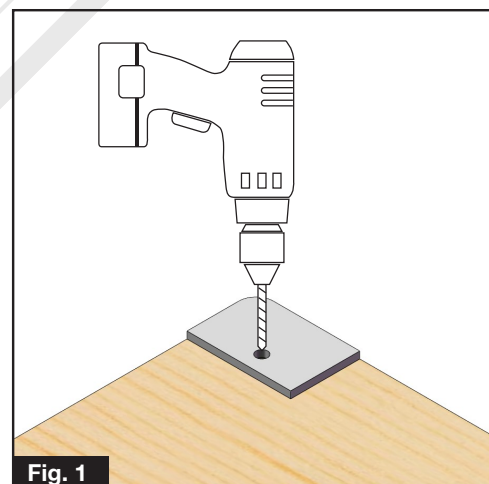
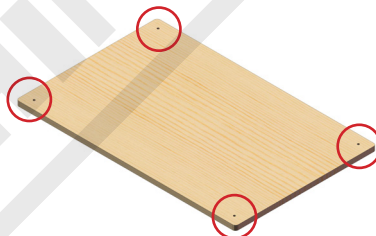

STEP 2.

Screw in Threaded Inserts

- Screw the threaded insert (5) into the drill hole as shown in Fig. 2. and screw down flush to tabletop using the S8 Allen Key (9).
- Repeat this process to all four sides of the work bench.

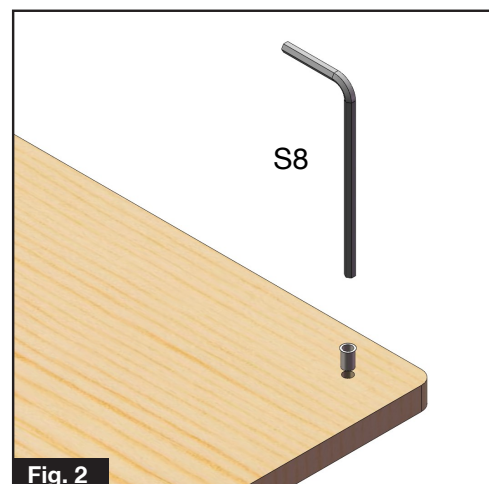

STEP 3.

Attach Panel with screws

- Position panel (4) onto work bench making sure all sides are flush.
- Pre-drill using a 2.5mm drill bit and fix into place with wood screws (3) using a Phillip Head Screwdriver on each corner as shown in Fig. 3.

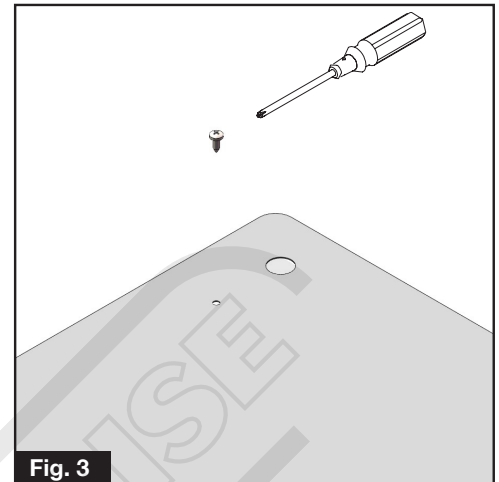
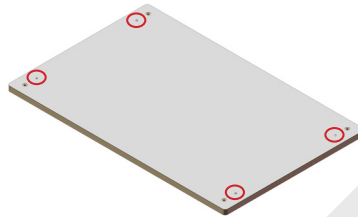

STEP 4.

Attach Welding Table to Bench Top

- Position Welding Table (2) onto work bench using correct lifting equipment making sure all 4 sides holes line up with the threading inserts.
- Start with 1 corner and using a socket head cap screw (1) screw loosely into the threading insert (5) using a S6 Allen Key (8). Repeat this process to the opposite corner and so forth until all four corners are screwed in. Lastly tighten all socket head cap screws (1) as shown in Fig. 4.

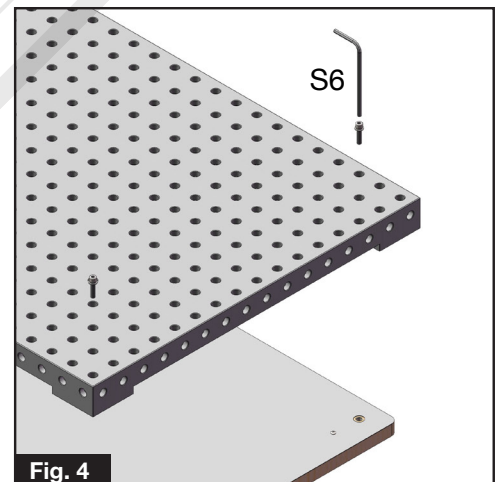
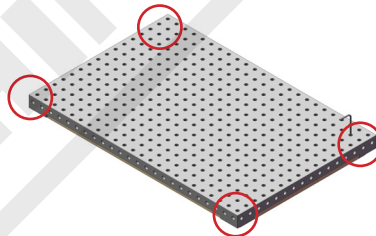

STEP 5.

Slide Tray under the Welding Table

- Using two persons, one on each side of tray (6), lift the tray (6) into position under the welding table, sliding it into place as shown in Fig. 5, making sure its sits flush and is not hanging out to cause any workplace hazards.

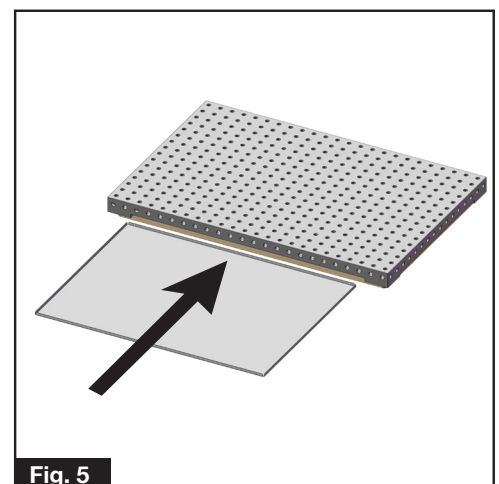
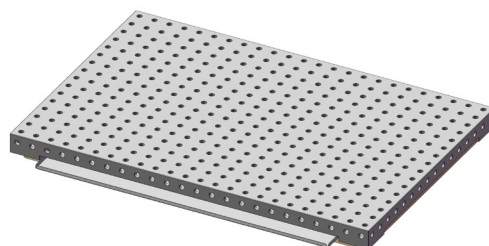



WARNING

General Machinery Safety Instructions

Machinery House
requires you to read this entire Manual before using this machine.

- 1. Read the entire Manual before starting machinery.** Machinery may cause serious injury if not correctly used.
- 2. Always use correct hearing protection when operating machinery.** Machinery noise may cause permanent hearing damage.
- 3. Machinery must never be used when tired, or under the influence of drugs or alcohol.** When running machinery you must be alert at all times.
- 4. Wear correct Clothing.** At all times remove all loose clothing, necklaces, rings, jewelry, etc. Long hair must be contained in a hair net. Non-slip protective footwear must be worn.
- 5. Always wear correct respirators around fumes or dust when operating machinery.** Machinery fumes & dust can cause serious respiratory illness. Dust extractors must be used where applicable.
- 6. Always wear correct safety glasses.** When machining you must use the correct eye protection to prevent injuring your eyes.
- 7. Keep work clean and make sure you have good lighting.** Cluttered and dark shadows may cause accidents.
- 8. Personnel must be properly trained or well supervised when operating machinery.** Make sure you have clear and safe understanding of the machine you are operating.
- 9. Keep children and visitors away.** Make sure children and visitors are at a safe distance for you work area.
- 10. Keep your workshop childproof.** Use padlocks, Turn off master power switches and remove start switch keys.
- 11. Never leave machine unattended.** Turn power off and wait till machine has come to a complete stop before leaving the machine unattended.
- 12. Make a safe working environment.** Do not use machine in a damp, wet area, or where flammable or noxious fumes may exist.
- 13. Disconnect main power before service machine.** Make sure power switch is in the off position before re-connecting.
- 14. Use correct amperage extension cords.** Undersized extension cords overheat and lose power. Replace extension cords if they become damaged.
- 15. Keep machine well maintained.** Keep blades sharp and clean for best and safest performance. Follow instructions when lubricating and changing accessories.
- 16. Keep machine well guarded.** Make sure guards on machine are in place and are all working correctly.
- 17. Do not overreach.** Keep proper footing and balance at all times.
- 18. Secure workpiece.** Use clamps or a vice to hold the workpiece where practical. Keeping the workpiece secure will free up your hand to operate the machine and will protect hand from injury.
- 19. Check machine over before operating.** Check machine for damaged parts, loose bolts, Keys and wrenches left on machine and any other conditions that may effect the machines operation. Repair and replace damaged parts.
- 20. Use recommended accessories.** Refer to instruction manual or ask correct service officer when using accessories. The use of improper accessories may cause the risk of injury.
- 21. Do not force machinery.** Work at the speed and capacity at which the machine or accessory was designed.
- 22. Use correct lifting practice.** Always use the correct lifting methods when using machinery. Incorrect lifting methods can cause serious injury.
- 23. Lock mobile bases.** Make sure any mobile bases are locked before using machine.
- 24. Allergic reactions.** Certain metal shavings and cutting fluids may cause an allergic reaction in people and animals, especially when cutting as the fumes can be inhaled. Make sure you know what type of metal and cutting fluid you will be exposed to and how to avoid contamination.
- 25. Call for help.** If at any time you experience difficulties, stop the machine and call you nearest branch service department for help.

NOTES:

Handwritten notes area with horizontal lines. A large, light gray watermark reading "MACHINERYHOUSE" is oriented diagonally across the page.



ENVIRONMENT PROTECTION

Recycle unwanted materials instead of disposing of them as waste. All tools, accessories and packaging should be sorted, taken to a recycling centre and disposed of in a manner which is compatible with the environment. When the product becomes completely unserviceable and requires disposal, drain any fluids (if applicable) into approved containers and dispose of the product and fluids according to local regulations.

Imported by

HARE & FORBES
MACHINERYHOUSE

Australian Distributor

Hare & Forbes
Machineryhouse
Sydney - Melbourne
Adelaide - Brisbane - Perth

Ph: 1300 202 200
www.machineryhouse.com.au

MACHINERYHOUSE

New Zealand Distributor

Machineryhouse
Auckland
Christchurch

Ph: 0800 142 326
www.machineryhouse.co.nz